

Street 45° Elbows		H	
P/N	DESCRIPTION	Min	Max
W3312	3/8" 45 Street Elbow	18.4	20.9
W3321	1/2" 45 Street Elbow	21.1	23.6
W3326	5/8" 45 Street Elbow	27.0	29.5
W3330	3/4" 45 Street Elbow	33.4	36.4
W3334	7/8" 45 Street Elbow	39.4	42.4
W3344	1-1/8" 45 Street Elbow	48.0	51.0
W3350	1-3/8" 45 Street Elbow	53.0	57.0
W3355	1-5/8" 45 Street Elbow	59.2	63.2
W3359	2-1/8" 45 Street Elbow	71.7	75.7
W3363	2-5/8" 45 Street Elbow	81.6	85.6

REVISION HISTORY			
REV	DESCRIPTIONS	DATE	APPROVED

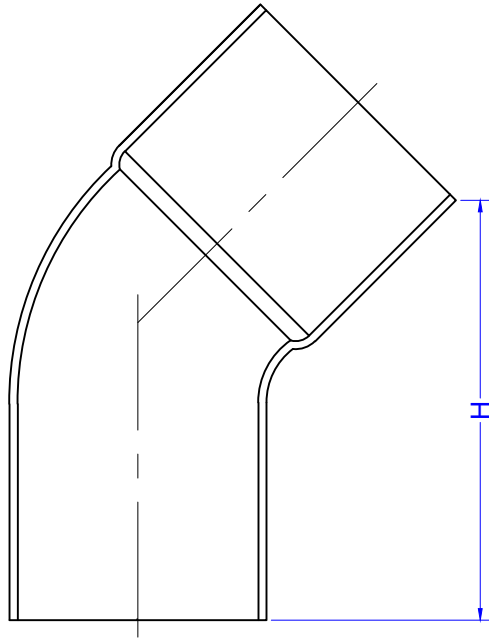

	NAME	DATE	NDL INDUSTRIES	
DRAWN	Winston Chen	4/02/2014	TITLE: ASME B16.22-2012, 45° STREET ELBOWS	
CHECKED			SIZE DWG. NO.:	
ENG APPR			A4	45° STREET ELBOWS
MATERIAL	C12200 ALLOY		REV	-
UNLESS OTHERWISE SPECIFIED DIMENSIONS ARE IN MILLIMETERS.			SCALE:	WEIGHT:
TOLERANCES ARE SPECIFIED IN DRAWING AND FITTING SIZE TABLE.			SHEET 1 OF 1	