

Material Selection

Thermoplastic and Elastomers

ABS

(Acrylonitrile-butadiene-styrene) Class 3-2-2-2-2, conforming to ASTM D3965, is a time proven material. The smooth inner surface and superior resistance to deposit formation makes ABS drain, waste and vent material ideal for residential and commercial sanitary systems. The residential DWV system can be exposed in service to a wide temperature span. ABS-DWV has proven satisfactory for use from -40°F to 160°F. These temperature variations can occur due to ambient temperature fluctuations or the discharge of hot liquids into the system. ABS-DWV is very resistant to a wide variety of materials ranging from sewage to commercial household chemical formulations. ABS-DWV is joined by solvent cementing or threading and can easily be connected to steel, copper, or cast iron through the use of transition fittings.

PVC

(Polyvinyl Chloride) conforming to ASTM D1784 Class 12454, formerly designated Type 1, Grade 1. PVC is the most frequently specified of all thermoplastic materials. It has been used successfully for over 30 years in such areas as chemical processing, industrial plating, chilled water distribution, deionized water lines, chemical drainage, and irrigation systems. PVC is characterized by high physical properties and resistance to corrosion and chemical attack by acids, alkalies, salt solutions and many other chemicals. It is attacked, however, by polar solvents such as ketones, some chlorinated hydrocarbons, and aromatics. The maximum service temperature of PVC is 140°F. With a design stress of 2,000 psi, PVC has the highest long-term hydrostatic strength at 73°F of any of the major thermoplastics being used for piping systems. PVC is joined by solvent cementing, threading, or flanging.

CPVC

(Chlorinated Polyvinyl Chloride) Class 23447, formerly designated Type IV, Grade 1 conforming to ASTM D1784, has physical properties at 73°F similar to those of PVC and its chemical resistance is similar to or generally better than that of PVC. CPVC, with a design stress of 2000 psi has, over a period of about 30 years, proven to be an excellent material for hot corrosive liquids, hot and cold-water distribution, and similar applications above the temperature range of PVC. CPVC is joined by solvent cementing, threading, or flanging.

PTFE

PTFE (Polytetrafluoroethylene) has outstanding resistance to chemical attack by most chemicals and solvents. PTFE has a temperature rating of -200°F to 500°F. PTFE, a self-lubricating compound, is used as a seat material in NIBCO/Chemtrol® ball valves.

FPM

FPM (Fluoroelastomers or Fluorocarbons) are inherently compatible with a broad spectrum of chemicals. Because of this extensive chemical compatibility, which spans considerable concentration and temperature ranges, fluorocarbons have gained wide acceptance as a material of construction for butterfly valve "O"-rings and seats. Fluorocarbons can be used in most applications involving mineral acids (with the exception of HCl), salt solutions, chlorinated hydrocarbons, and petroleum oils.

EPDM

EPDM is a terpolymer elastomer made from ethylene, propylene and diene monomer. EPDM has good abrasion and tear resistance and offers excellent chemical resistance to a variety of acids and alkalines. It is susceptible to attack by hydrocarbons and is not recommended for applications involving petroleum oils, strong acids, or strong alkalines.

Material Selection

Plastic Piping Standards

ASTM Test Methods	Properties	Material		
		ABS 3-2-2-2-2	PVC 12454	CPVC 23447
General D792	Specific Gravity	1.00 - 1.08	1.38	1.55
D570	Water Absorption % 24 Hrs. @ 73°F	0.3	0.05	0.05
Mechanical D638	Tensile Strength psi @ 73°F	4,500	7,000	7,000
D638	Modulus of Elasticity in Tension psi @ 73°F x 10 ⁵	2.4	4.0	3.6
D790	Flexural Strength psi	10,000	14,500	15,600
D256	Izod Impact Strength @ 73°F (Notched)	4.0	0.65	1.5
Thermal D696	Coefficient of Thermal Expansion in/in/°F x 10 ⁻⁵	5.0	3.0	3.8
C177	Thermal Conductivity BTU/HR/Sq. Ft./°F/in	1.35	1.2	0.95
D648	Heat Distortion Temp. °F @ 66 psi	219	165	238
D648	Heat Distortion Temp. °F @ 264 psi	180	158	212
	Resistance to Heat °F at Continuous Drainage	180	140	210
Flammability D2863	Limiting Oxygen Index (%)	19	43	60
E84	Flame Spread	150-250	15-20	15
	Underwriter's Lab Rating (Sub. 94)	94HB	94V-0	94V-0

Plastic Piping Standards

Many commercial, industrial, and governmental standards or specifications are available to assist the design engineer in specifying plastic piping systems. Standards most frequently specified in plastic piping systems are ASTM International. Following is a list and description of those standards most typically applied to industrial plastic piping.

ASTM Standard D1784

This standard covers PVC and CPVC compounds used in the manufacture of plastic pipe, valves, and fittings. It provides a means for selecting and identifying compounds on the basis of a number of physical and chemical criteria. Conformance to a particular material classification in this standard requires meeting a number of minimum physical and chemical properties.

ASTM Standards D2665 and D3311

These standards provide the material and test requirements as well as the fitting geometries for PVC-DWV (drain, waste and vent) fittings. These fittings are joined by threading or solvent cementing.

ASTM Standard D2466

This standard covers Schedule 40 PVC threaded and socket pressure fittings. Included in the standard are thread and socket specifications, lay length, wall thickness, burst, material, quality, and identification requirements.

ASTM Standard D2467

This standard covers Schedule 80 PVC threaded and socket fittings. Included in the standard are thread and socket specifications, lay length, wall thickness, burst, material, quality, and identification requirements.

ASTM Standard D2846

This standard covers plastic hot and cold-water distribution system components made in one standard dimension ratio. This includes a series of CTS (copper tube size) CPVC fittings meant for use with SDR 11 tube and plastic-to-metal transition fittings.

ASTM Standard D3965

This standard covers ABS compounds used in the manufacture of pipe and fittings. It identifies the chemical and physical properties of several ABS compositions based upon impact strength, deflection temperature under load, and tensile stress at yield point. These properties identify the polymers or blends of polymers that make up this rigid thermoplastic material.

ASTM Standards D2661 and D3311

These standards cover ABS-DWV (drain, waste and vent) by material and by physical configuration. These products are threaded or joined by solvent cement.

ASTM Standard F1498

This standard covers dimensions, tolerances, and gaging of tapered pipe threads used on plastic ends of pipe and fittings.

Material Selection

Plastic Piping Standards and Chemical Resistance

ASTM Standard F1970

This standard covers fittings and appurtenances intended to be used in PVC or CPVC plastic piping, or as a transition from such systems to metal systems. These products, such as unions, flanges, or valves, are not included in the scope of other ASTM specifications.

ASME B1.20.1 (American Society of Mechanical Engineers)

This specification details the dimensions, tolerances, and gaging of tapered pipe threads used on metallic ends of pipe and fittings, plus machined plastic threaded ends.

NSF/ANSI Standard 14 (NSF International)

This standard establishes the minimum physical and performance requirements for plastic piping system components and related materials. It also provides a basis for certification of products to consensus standards, or other physical and performance requirements where no consensus standard exists. It requires adherence to appropriate ASTM Standards and specifies minimum quality control programs. To comply with this standard the manufacturer must allow periodic testing of product and auditing of procedures by a third-party agency.

NSF/ANSI Standard 372

This standard establishes procedures for determination of lead content based on the wetted surface area within the product. This standard is used in conjunction with NSF/ANSI 61 for the purpose of compliance with the Safe Drinking Water Act (SDWA), the federal law that ensures the quality of America's public drinking water supply.

NSF/ANSI Standard 61

At the request of the U.S. Environmental Protection Agency (EPA), a consortium led by NSF International developed this standard. It was developed to establish minimum requirements for the control of potential adverse human health effects from products which contact drinking water. This Standard complements the performance requirements that are contained within ASTM product standards. NIBCO® PVC & CPVC fitting products intended for potable water applications are tested and certified by a third-party agency for compliance to ANSI/NSF Standard 61.

CSA (Canadian Standards Association)

CSA Group has several codes including the Canadian Plumbing Code as well as numerous standards. Several third party agencies provide testing and certification to show compliance with these codes and standards. For further information on third party listings contact NIBCO customer service.

IAPMO (International Association of Plumbing and Mechanical Officials)

IAPMO has several codes including the Uniform Plumbing Code (UPC). Many products are third party tested and listed showing compliance to this code by one or more third party agencies. For further information contact NIBCO customer support.

Chemical Resistance

Thermoplastics exhibit a 'GO' or 'NO-GO' type of resistance when contacted by aggressive chemicals. That is, they either resist attack completely or they deteriorate rapidly, in which case, the mechanism of attack is either solvation or reaction with the base molecule. Solvation, which is the most common form of attack, involves penetration of a chemical into the plastic causing softening, swelling, and loss of physical properties. Reaction with the base molecule involves the breakage of the molecular chain, crosslinking, or substitution reactions.

The NIBCO *Chemical Resistance Guide* contains specific chemical resistance information for the various plastic and elastomeric materials used in the NIBCO product line. When interpreting the information presented in this brochure it is important to note that it is based only on unstressed immersion testing at the temperatures noted, using pure chemicals or saturated solutions, except where otherwise specified. It is unwise to specify a plastic material without chemical resistance information relative to the specific environment of the intended application. Therefore, in situations where the aggressive environment involves a mixture of chemicals, the Chemical Resistance Guide can be used to investigate the effects of individual chemicals; however, because of possible synergisms, the suitability of a particular plastic for handling a chemical mixture should be verified. Also, since chemicals are more aggressive at higher temperatures and concentrations, chemical resistance information should not be extrapolated to higher temperatures and concentrations. Conversely, chemicals are generally less aggressive at lower temperatures and concentrations; therefore, extrapolation of chemical resistance information to lower temperatures and concentrations is generally acceptable.

When chemical resistance information is not available or a first-of-a-kind process is involved, data may be obtained through immersion testing. ASTM D543 provides a method for conducting such tests, and the chemical, as well as, the temperature used in this test should be identical to the anticipated process condition.

Key to NIBCO Figure Numbers

DWV Fittings 1 2 3 4 - 5

1 2 TYPE OF MATERIALS

48 = PVC
58 = ABS

3 4 TYPE OF FITTING & DESCRIPTION

01 = Coupling
03 = Female Adapter
04 = Male Adapter
05 = Soil Pipe Adapter
06 = 45° EII
07 = 90° EII
08 = 22½° EII
10 = Wye
11 = Tee
12 = Long Turn TY
14 = Test Tee
16 = Cleanout
17 = Cap
18 = Plug
19 = Blind Flange
26 = Plug (Spg)
27 = Cap (FIPT)
28 = Cross
29 = Nipple
30 = True Y
34 = Double Y
35 = Double Tee
36 = Double Long Turn TY

37 = Double EII
48 = Offset Closet Flange
51 = Closet Flange
53 = Closet Flange-Flush
55 = Closet Flange w/Knockout Test Plug
60 = 60° EII
61 = 90° EII w/Heel Inlet
63-73 = Various Stack Fittings
76 = Return Bend w/CO Hub x SJ
77 = Return Bend Hub x SJ
78 = Return Bend w/CO Hub x Hub
79 = Return Bend Hub x Hub
80 = P-Trap w/CO Hub x SJ
81 = P-Trap Hub x SJ
84 = P-Trap w/CO Hub x SJ
85 = P-Trap Hub x Hub
91 = Drum Trap
92 = P-Trap w/Union Hub x SJ
95 = P-Trap w/Union Hub x Hub

5 TYPE OF CONNECTIONS

Numerical Suffix
2 = Fitting Connection
3 = Female Connection
4 = Male Connection
7 = Slip Joint Connection
9 = Side Inlet
13 = Female Connection Indicating Hub x FIPT x Hub
14 = Female Connection Indicating Hub x Hub x FIPT
16 = Female Connection Indicating Hub x CO x Hub
17 = Female Connection Indicating FIPT x Hub x Hub
18 = Female Connection Indicating Tee x FIPT x Hub
19 = Baffle Tee Hub x Hub x Hub

Letter Suffix
A = Adjustable Closet Flange
B = Double Fixture Tee
BAF = Baffle
CL = Water Closet EII
CLAY = Clay
CO = Cleanout
DC = Dust Cap
DP = Dust Plug
EH = Extra Heavy
EL = Extra Long
F = Flush
FX = Fixture Tee
KO = Knockout
L = Lead & Left
LH = Low Heel
LR = Long Radius

LT = Long Turn
N = No Hub
NS = No Stop
P = Fits Pipe I.D.
R = Right
RP = Repair
S = Stack Upturn
SD = Sewer Drain
ASTM-D2852
SE = Special
TE = Trap El
TPA = Tray Plug Adapter
TY = TY-Seal
V = Vent
XL = Extra Long

Schedule 40 - PVC Plastic Fittings

UNIV. PART NO.	DESCRIPTION	END CONNECTIONS	SIZE KEY STRAIGHT SIZES		SIZE KEY REDUCING SIZES		SIZE KEY REDUCING SIZES	
401	Tee	Slip x Slip x Slip	1/4	002	1/2 x 1/2 x 1/4	072	2 x 1½ x 3/4	238
402	Tee	Slip x Slip x FIPT	3/8	003	1/2 x 1/2 x 3/4	074	2 x 1½ x 1	239
405	Tee	FIPT x FIPT x FIPT	1/2	005	3/4 x 1/2 x 1/2	094	2 x 1/2 x 1½	241
406	90° EII	Slip x Slip	3/4	007	3/4 x 1/2 x 3/4	095	2 x 2 x 1/2	247
407	90° EII	Slip x FIPT	1	010	3/4 x 3/4 x 1/2	101	2 x 2 x 3/4	248
408	90° EII	FIPT x FIPT	1¼	012	3/4 x 3/4 x 1	102	2 x 2 x 1	249
409	90° Street EII	Spg x Slip	1½	015	1 x 1/2 x 1	122	2 x 2 x 1¼	250
410	90° EII	MIPT x Slip	2	020	1 x 3/4 x 1/2	124	2 x 2 x 1½	251
411	90° Street EII	Spg x FIPT	2½	025	1 x 3/4 x 3/4	125	2½ x 2½ x 1/2	287
412	90° Street EII	MIPT x FIPT	3	030	1 x 3/4 x 1	126	2½ x 2½ x 3/4	288
414	90° Side Outlet EII	Slip x Slip x FIPT	4	040	1 x 1 x 1/2	130	2½ x 2½ x 1	289
417	45° EII	Slip x Slip	5	050	1 x 1 x 3/4	131	2½ x 2½ x 1¼	290
420	Cross	All Slip	6		1 x 1 x 1¼	132	2½ x 2½ x 1½	291
429	Coupling	Slip x Slip	060		1 x 1 x 1½	133	2½ x 2½ x 2	292
430	Coupling	FIPT x FIPT	8	080	1¼ x 1 x 1/2	156	3 x 3 x 1/2	333
434	Riser Extender	MIPT x FIPT	10	100	1¼ x 1 x 3/4	157	3 x 3 x 3/4	334
435	Female Adapter	Slip x FIPT	12	120	1¼ x 1 x 1	158	3 x 3 x 1	335
436	Male Adapter	MIPT x Slip			1¼ x 1¼ x 1/2	166	3 x 3 x 1¼	336
437	Bushing	Slip x Slip			1¼ x 1¼ x 3/4	167	3 x 3 x 1½	337
438	Bushing	Spg x Slip			1¼ x 1¼ x 1	168	3 x 3 x 2	338
439	Thread Bushing	MIPT x FIPT			1½ x 1¼ x 1/2	199	3 x 3 x 4	342
447	Cap	Slip			1½ x 1¼ x 3/4	201	4 x 4 x 3/4	416
448	Thread Cap	FIPT			1½ x 1¼ x 1	202	4 x 4 x 1	417
449	Plug	Spg			1½ x 1½ x 1/2	209	4 x 4 x 1¼	418
450	Thread Plug	MIPT			1½ x 1½ x 3/4	210	4 x 4 x 1½	419
475	Wye	All Slip			1½ x 1½ x 1	211	4 x 4 x 2	420
488	Running Trap	Spg x Spg			1½ x 1½ x 1¼	212	4 x 4 x 3	422
489	P-Trap	Spg x Spg			1½ x 1½ x 2	213		

Fitting Terms and Abbreviations

FIPT = Female NPT Thread	Schedule 40 Only	Schedule 80 Only	CPVC-CTS Only
Spg = Male End (Spigot)	FIPT = Female NPT Thread	FIPT = Female NPT Thread	C = Copper Solder Joint (Transition)
MIPT = Male NPT Thread	MIPT = Male NPT Thread	CL = Close	Compression = Transition Fitting
NPSM = Straight Thread for Mechanical Joint	Slip = Female Socket	MIPT = Male NPT Thread	FIPT = Female NPT Thread
SJ = Slip Joint	Spg = Male End (Spigot)	Slip = Female Socket	MIPT = Male NPT Thread
Hub = Plastic Socket	Ball Valve	SH = Short	Slip = Female Socket
	S = Socket	Spg = Male End (Spigot)	Spg = Male End (Spigot)
	T = Threaded		IPS = Iron Pipe Size
			CTS = Copper Tube Size

Methods of Designating Inlets of Fittings

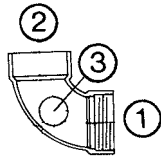

DWV 90° Ell w/Side Inlet

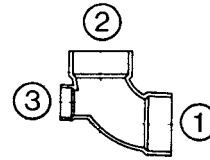

DWV 90° Ell w/High Heel Inlet

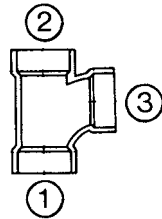

DWV Sanitary Tee

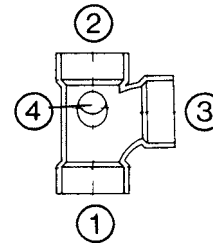

DWV Tee w/90° Right/Left Inlet

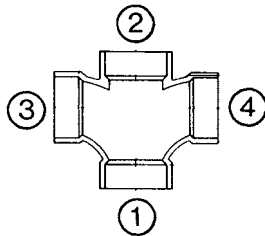

DWV Double Sanitary Tee

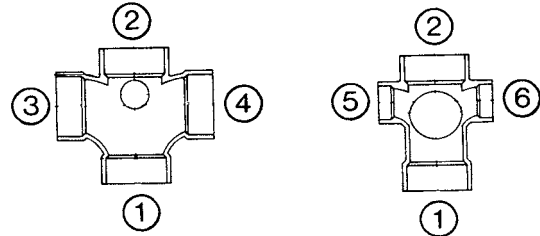

DWV Double Tee w/Two 90° Side Inlets

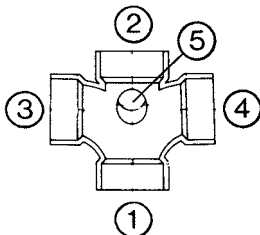

DWV Double Tee w/One 90° Side Inlet

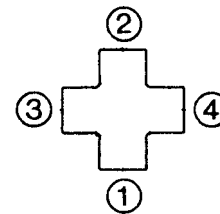

Cross

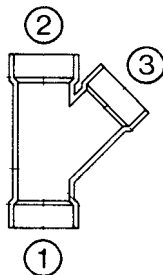

DWV 45° Y

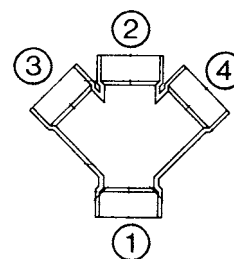

DWV 45° Double Y

General Note:

The largest opening establishes the basic size of a reducing fitting. The largest opening is named first, except for double branch elbows where both branches are reducing; the outlet is the largest opening and named last in both cases. In designating the openings of reducing fittings, they should be read in the order indicated by the sequence of the numbers 1, 2, 3, 4, 5 and 6. In designating the outlets of side outlet reducing fittings, the side outlet is named last.

ABS & PVC-DWV Fittings

5800 Series ABS/4800 Series PVC

ELBOWS (Continued)

5807-V 4807-V

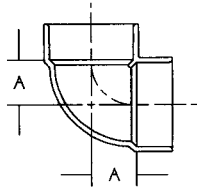

90° Vent Ell (Hub x Hub)

NOM. SIZE	ABS APPROX. NET WT./LBS.	PVC APPROX. NET WT./LBS.	DIM. A INCHES
* 1 ¹ / ₄	.106	N/A	1
1 ¹ / ₂	.145	.190	1 ³ / ₁₆
2	.194	.255	1 ¹ / ₂
3	.584	.839	1 ⁷ / ₈
4	1.048	1.547	2 ¹ / ₂
10	N/A	19.410	5 ¹³ / ₁₆
12	N/A	25.940	6 ⁷ / ₈

5807-2 4807-2

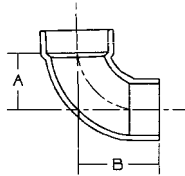

90° Street Ell (Spig x Hub)

NOM. SIZE	ABS APPROX. NET WT./LBS.	PVC APPROX. NET WT./LBS.	DIM. A INCHES	DIM. B INCHES
1 ¹ / ₄	.120	.164	1 ²¹ / ₃₂	2 ⁵ / ₁₆
1 ¹ / ₂	.154	.200	1 ³ / ₄	2 ¹ / ₂
2	.240	.313	2 ⁵ / ₁₆	3 ³ / ₁₆
3	.731	.993	3 ¹ / ₁₆	4 ⁹ / ₁₆
4	1.224	1.731	3 ⁷ / ₈	5 ⁵ / ₈
6	3.319	4.530	5 ⁵ / ₈	8 ⁵ / ₈

5807-2-CL 4807-2-CL

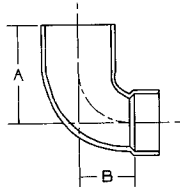

90° Street Closet Ell (Spig x Hub)

NOM. SIZE	ABS APPROX. NET WT./LBS.	PVC APPROX. NET WT./LBS.	DIM. A INCHES	DIM. B INCHES
4 x 3	1.137	1.541	6	3 ³ / ₈
4 x 3 w/Cap F	1.182	1.586	6	3 ³ / ₈

5807-2-LT 4807-2-LT

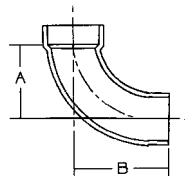

90° Long Turn Street Ell (Spig x Hub)

NOM. SIZE	ABS APPROX. NET WT./LBS.	PVC APPROX. NET WT./LBS.	DIM. A INCHES	DIM. B INCHES
1 ¹ / ₂	.214	.286	2 ³ / ₄	3 ¹ / ₂
2	.293	.407	3 ⁷ / ₃₂	4 ³ / ₃₂
3	.854	1.138	4 ¹ / ₁₆	5 ⁹ / ₁₆
4	1.477	2.021	4 ¹⁵ / ₁₆	6 ¹¹ / ₁₆

5807-2-V 4807-2-V

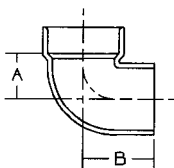

90° Street Vent Ell (Spig x Hub)

NOM. SIZE	ABS APPROX. NET WT./LBS.	PVC APPROX. NET WT./LBS.	DIM. A INCHES	DIM. B INCHES
1 ¹ / ₂	.120	.173	1 ³ / ₁₆	1 ¹⁵ / ₁₆
2	.183	.251	1 ¹ / ₂	2 ³ / ₈
†3	.575	.930	1 ⁷ / ₈	3 ³ / ₈

* Available in ABS only

† Available in PVC only

F Fabricated

Do not use or test the products in this catalog with compressed air or other gasses.

Plastic Irrigation Products

PVC SCHEDULE 40 BALL VALVES

NIBCO® PVC Schedule 40 Ball Valves are excellent for use in cold water pressure distribution systems in residential, commercial, agricultural and light industrial applications. Sizes range from 1/2" through 4" IPS. These valves feature a durable one-piece molded body, convenient quarter-turn action, and their 100 percent thermoplastic design eliminates process or atmospheric corrosion. PVC has excellent rigidity, corrosion and chemical resistance properties. PVC Schedule 40 Ball Valves are NSF approved and manufactured in an ISO 9002 certified facility. (Refer to page 55 for additional information)



PLASTIC FITTINGS



NIBCO® PVC Schedule 40 Pressure Fittings are ideal for use in irrigation, golf course construction, pool & spa, potable water, and chilled-water applications. PVC, one of the most frequently specified of all thermoplastic materials, has a high resistance to corrosion and chemical attack by acids, alkalies, salt solutions, and many other chemicals.

ABS DWV fittings are used for residential and commercial drain, waste, and vent non-pressure applications. ABS is an excellent high strength, high-impact thermoplastic material, resistant to a wide variety of materials ranging from sewage to commercial household chemical formulations. ABS is lightweight, safe to handle and easy to install.

PVC DWV fittings have been used for over 50 years in residential and commercial drain, waste, and vent non-pressure applications. PVC DWV can be found in such areas as chemical processing, industrial plating, chilled water distribution, chemical drainage and irrigation systems.

Do not use or test the products in this catalog with compressed air or other gasses.

Pressure Ratings

Pipe and Tube

¹Based on water service, for more severe service, an additional correction factor may be required.

Maximum Non-Shock Operating Pressure (psi) AT 73°F ¹			
Nominal Size	Schedule 40 PVC	Schedule 80 PVC	CPVC-CTS SDR-11
3/8	620	920	400
1/2	600	850	400
3/4	480	690	400
1	450	630	400
1 1/4	370	520	400
1 1/2	330	470	400
2	280	400	400
2 1/2	300	425	N/A
3	260	375	N/A
4	220	325	N/A
6	180	280	N/A
8	160	250	N/A
10	140	230	N/A
12	130	230	N/A

NOTE: ABS & PVC DWV used for non-pressure applications only.
N. R. - Not Recommended.
N/A - Not Available.

Pipe and tube pressure ratings are based on non-shock service. As the severity of the service application increases, a service-correction factor should be considered. Specifically, for Schedule 40 applications that may experience severe cyclinical-pressure loading, such as in irrigation systems, the following maximum-suggested design pressures are suggested.

Systems with threaded Schedule 80 thermoplastic fittings shall have a maximum-suggested design pressure of 50% that of equivalent pipe size pressure rating. This reduction is because threads are formed by the removal of material. Refer to the following table for maximum-suggested design pressures.

Conversely, CPVC-CTS pipe and fittings do carry the same pressure rating, as defined by ASTM D2846. Refer to the following table for maximum-suggested design pressures.

Fittings with Service Correction Factors

NOTE: ABS & PVC DWV used for non-pressure applications only.

Maximum-Suggested Design Pressure (psi) AT 73°F ¹			
Nominal Size	Schedule 40 PVC	Schedule 80 PVC	CPVC-CTS SDR-11
	Socket End	Threaded End	Socket End
3/8	370	460	400
1/2	360	420	400
3/4	280	340	400
1	270	320	400
1 1/4	220	260	400
1 1/2	200	240	400
2	170	200	400
2 1/2	180	210	N/A
3	155	190	N/A
4	130	160	N/A
6	110	N.R.	N/A
8	95	N.R.	N/A
10	85	N.R.	N/A
12	80	N.R.	N/A

N. R. - Not Recommended.
N/A - Not Available.

The maximum-allowable non-shock pressure rating for PVC and CPVC-CTS thermoplastic piping is a function of temperature. For pipe and fitting applications above 73°F, refer to the table on the following page for temperature correction factors. To determine the maximum non-shock pressure rating at an elevated temperature, simply multiply the base pressure rating obtained from the appropriate table by the correction factor from the following table. Below 73°F the pressure rating will be the same as the base pressure in the tables above.



NIBCO® Plastic Fittings Warranty

NIBCO INC. LIMITED WARRANTY

Applicable to NIBCO INC. Plumbing Plastic Fittings and Valves

NIBCO INC. warrants each NIBCO® plumbing plastic fitting (including plumbing valves) to be free from defects in material and workmanship under normal use and service for a period of five (5) years from the date of purchase.

In the event any defect occurs which the owner believes is covered by this warranty, the owner should immediately contact NIBCO Technical Services, either in writing or by telephone at 1.888.446.4226 or 1.574.295.3000. The owner will be instructed to return said fitting or valve, at the owner's expense, to NIBCO INC. or an authorized NIBCO INC. representative for inspection. In the event said inspection discloses to the satisfaction of NIBCO INC. that said fitting or valve is defective, a replacement shall be mailed free of charge to the owner, and NIBCO INC. shall further pay the installing contractor the sum of ten (\$10.00) dollars to apply on the cost of installation of said replacement fitting or valve.

TO THE EXTENT PERMITTED BY APPLICABLE LAW, THIS WARRANTY SPECIFICALLY EXCLUDES INCIDENTAL AND CONSEQUENTIAL DAMAGES OF EVERY TYPE AND DESCRIPTION RESULTING FROM ANY CLAIMED DEFECT IN MATERIAL OR WORKMANSHIP, INCLUDING BUT NOT LIMITED TO, PERSONAL INJURIES AND PROPERTY DAMAGES.

Some states do not allow the exclusion or limitations of incidental or consequential damages, so these limitations may not apply to you.

TO THE EXTENT PERMITTED BY APPLICABLE LAW, IMPLIED WARRANTIES OF MERCHANTABILITY AND FITNESS FOR A PARTICULAR PURPOSE ARE LIMITED IN DURATION.

This warranty gives you specific legal rights, and you may also have other rights which vary from state to state and country to country.



How to Order

State quantity, figure number and size for each valve or fitting you wish to order. See individual catalog pages for specific or special product designations.

HOW MANY TO ORDER

NIBCO® valves and fittings are decimal packed for your convenience in handling, shipping and stock-keeping. Number in master carton varies with item.

POLICY ON RETURNS TO FACTORY

No NIBCO valves and fittings are to be returned without prior written agreement. Transportation must be prepaid. A 20% charge will be made to cover cost of rehandling and reinspection.

TECHNICAL ASSISTANCE

Engineers, contractors, wholesalers or manufacturers may obtain special or technical assistance from any factory representative of NIBCO. Write, fax or phone.

NIBCO INC.
World Headquarters
1516 Middlebury Street
Elkhart, IN 46516-4740
USA

PH: 1.574.295.3000 or 1.888.446.4226
FAX: 1.574.295.3307 or 1.888.336.4226

To the best of our knowledge, the information contained in this publication is accurate. However, NIBCO does not assume any liability whatsoever for the accuracy or completeness of such information. Final determinations of the suitability of any information or product for the use to be contemplated is the sole responsibility of the user. The manner of that use, and whether there is any infringement of patents, is also the sole responsibility of the user.